

RAIL LINE

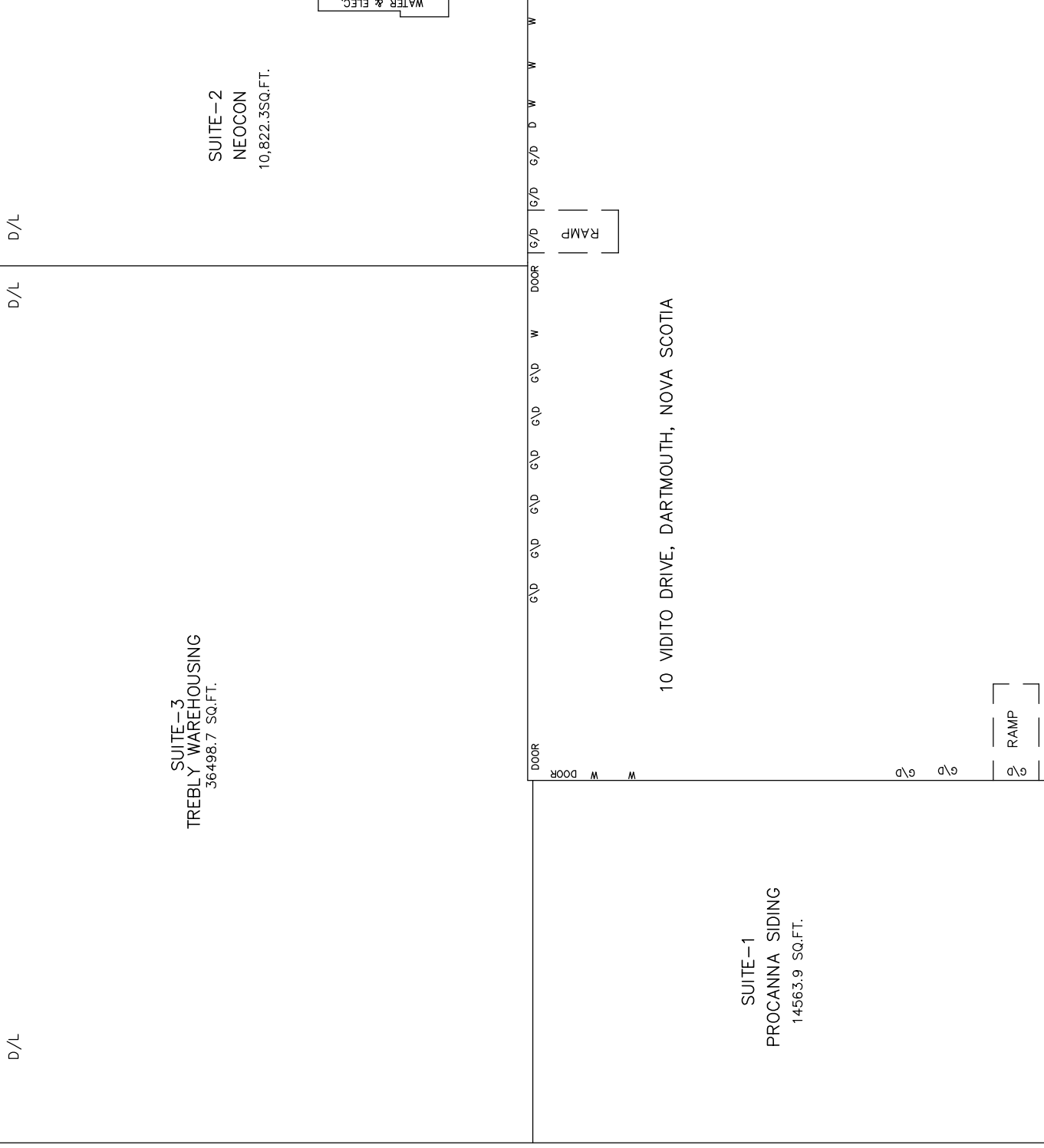

SUITE-3
TREBLEY WAREHOUSING
36498.7 Sq.Ft.

SUITE-2
NEOCAN
10,822.3Sq.Ft.

SUITE-1
PROCANNA SIDING
14563.9 Sq.Ft.

10 VIDITO DRIVE, DARTMOUTH, NOVA SCOTIA



SKETCH SHOWING
 INDUSTRIAL AND RETAIL BUILDINGS
 PROPERTY MANAGED BY
20 VIC MANAGEMENT INC.
 HALIFAX AND DARTMOUTH, NOVA SCOTIA

DATE: MAY 27, 2010
 FILE NO.: 12858
 NOT TO SCALE

LEGEND:
 D/L DOCK LOADING
 G/L GROUND LOADING
 W WINDOW

THOMPSON CONN LIMITED
 NOVA SCOTIA LAND SURVEYORS
 HALIFAX, NOVA SCOTIA